

4G Dashcam

Product User Manual



Model: T98 Single Channel

Version: V1.0

Note: Please read the product manual thoroughly before use and keep it in a safe place for future reference.

CONTENTS

1. Product Overview	3
2. Product Appearance	3
3. Product Parameters.....	4
4. Product Functions.....	5
5. Installation Guide.....	7
6. Definition of Indicator lights.....	8
7. Connection Definition.....	9
8. Analysis of Common Problems	9
9. Precautions	10

1. Product Overview

T98 Single Channel AI is a compact dashcam specifically designed to fulfill the requirements of modern vehicle monitoring systems. It incorporates positioning functionality, 4G communication capabilities, LoRa, ADAS, as well as video storage and transmission features. The device supports 1-channel real-time 1080P video recording, remote live streaming, video playback, and trajectory playback. Additionally, it can provide I/O port for data transfer.

2. Product Appearance



3. Product Parameters

Features		Specifications
Operation system	Operation system	Linux
Video& Audio	Video Quality/Bitrate	Main stream: 1080P@25fps/2Mbps Sub-stream: 1080P@12fps/512Kbps
	Resolution	1920*1080 (1080P)
	Video input	1 channel (Built-in camera)
	Image format	JPEG
	Video format	BSV
	Video encoding	H.265 (default)/H.264
	Audio encode	G711A
	Audio Input	Built-in MIC
	Audio Output	Built-in Speaker
	Video playback	1 channel
	External storage	1 Micro SD card, up to 512GB
	Camera	Built-in camera
Cellular	Technology	4G LTE Cat. 1
	Bands	LTE FDD: B1, B2, B3, B5, B7, B8, B20, B28, B66, B4 LTE-TDD: B38, B41
	Data transfer	LTE Cat.1: Max10Mbps (DL)/Max5Mbps (UL)
	Data support	SMS(TXT/PDU)
GNSS	Technology	GPS, BDS, GLONASS, Galileo, QZSS
Power	Power supply	DC 9V-36V

Other features	Dimension	L107*W60*H37mm
	Weight	About 145g
	eMMC (Optional)	8G (default)
	LoRa	Support
	WIFI	N/A
	Bluetooth	N/A
	Indicator Light	Cellular (Red); Positioning (Yellow); Recording (Green)

4. Product Functions

Item	Function	Description
Multimedia	Video Recording and Playback	Continuous loop recording and video playback.
	Storage	1 Micro SD card, support a maximum storage capacity of 512GB.
	Capture	The monitoring platform transmits commands to initiate the capture of surveillance footage.
	Video upload of urgent events	Emergency video uploads automatically or manually.
	Time-lapse video archiving	Support 300s time-lapse recording after ACC off.
	Audio surveillance	Support platform for remote audio surveillance of vehicles.
	Remote intercom	Support remote intercom between the platform and the device by initiating intercom requests from the platform.
Positioning and location	Real-time Positioning and Trajectory Playback	Supports GPS, BDS, GLONASS, and Galileo for real-time positioning. Provides accurate tracking of vehicle routes with detailed playback capabilities.
	Tracking	Transmit geographical positioning data, including latitude and longitude, at the predetermined time intervals.

	Offline data caching and auto – transmission	When the terminal is offline but has acquired location data, such information will be temporarily stored on the device. Upon re-establishing a stable connection and successfully going online, the accumulated location data will be automatically transmitted to the server.
	Orientation threshold - driven trajectory optimization	When the orientation exceeds a specified threshold, it will immediately send positional data to optimize the trajectory, preventing from prevent a linear path.
Vehicle condition monitoring	Ignition status	Every location data packet contains the ACC status.
	Vibration alarm	Trigger vibration alarm on the platform when the vibration value exceeds the specified threshold.
	Low voltage alarm	Keep detecting the voltage for 60s. When the detection voltage is less than the specified voltage limit, a low voltage alarm is generated.
	Speeding alarm	Set the maximum speed limit value through the platform. When the speed exceeds the limit value, a speeding alarm will be transmitted to the platform.
	Collision wake-up	When operating in smart sleep mode, the device is capable of waking up upon detecting a collision event.
	Harsh acceleration	When the device is accelerating, if the acceleration exceeds a specified threshold, the system will trigger alerts on the platform.
	Harsh deceleration	When the device is decelerating, if the acceleration exceeds a specified threshold, the system will trigger alerts on the platform.
	Harsh cornering	Trigger alerts on the platform when the speed and turning angle exceed the specified thresholds.
AI Functionalities	ADAS (Optional)	ADAS focuses on road risk alerts, including Lane Departure Warning (LDW), Forward Collision Warning (FCW), Pedestrian Collision Warning, and Safe Distance Warning—all to predict and

		warn of potential road hazards.
Other functions	Sleep mode	When the equipment is powered on, if it remains vibration-free for a continuous period of 5 minutes, it will transition into a sleep mode.
	Remote wake-up	Achieve remote wake-up of the device by initiating commands through the platform.
	SOS alarm	Equipped with an SOS button to enable rapid response to emergencies, thereby minimizing potential risks and ensuring both driver safety and the uninterrupted operation of services.

5. Installation Guide

5.1 Micro SD Card & SIM Card Installation



5.2 Installation Position

It is recommended to install the dashcam on both sides of the central rear - view mirror on the inner side of the front windshield. For the wiring method, please refer to the following diagram:

(1) For connecting to the constant power supply (fuse box), refer to A - B.

(2) For connecting to the cigarette lighter or USB power cable, refer to A - C.

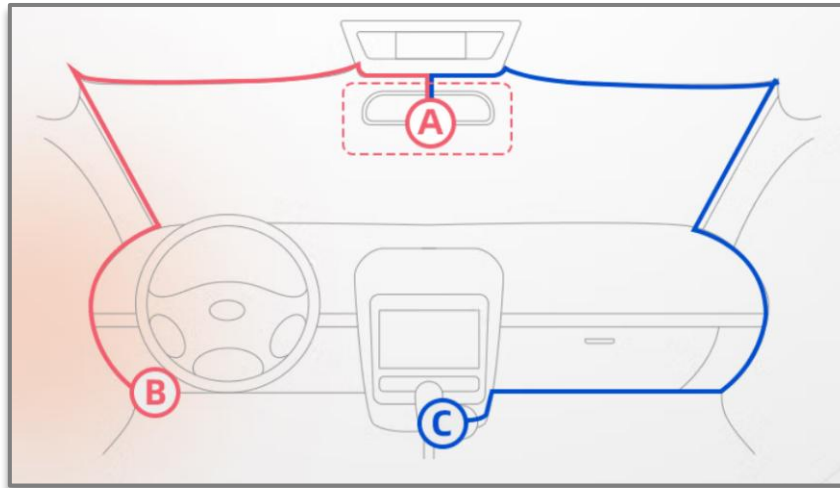

Note: The fuse box of most vehicles is located on the left side of the dashboard or near the steering wheel. For specific details, please refer to the vehicle's user manual.

6. Definition of Indicator lights

Name	Indicator Light Status Description	
Indicator Lights Definition	Cellular (Red)	Always on: Connected successfully Blinking (fast): Searching for the network Blinking (slow): No SIM card detected
	Positioning (Yellow)	Always on: Positioning completed Blinking (fast): Searching for the satellite Always off: Positioning is abnormal
	Recording (Green)	Always on: Video recording is normal Blinking: Micro SD card is abnormal Always off: No Micro SD card inserted

7. Connection Definition

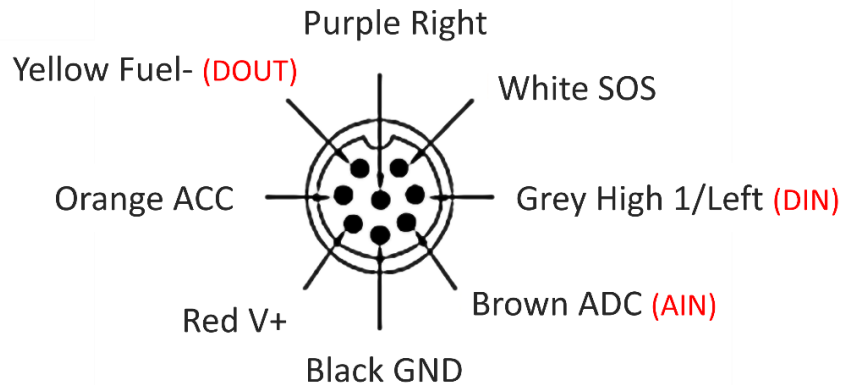

8. Analysis of Common Problems

Fault Phenomenon	Reason Analysis	Solution
The image is reflective	The front windshield exhibits light reflection	Adjust the camera to a proper angle to enhance video effect
Great difference between day and night video effect	Nighttime imaging is affected by lower illumination compared to daytime, which is a normal phenomenon	N/A
Failed to initialize device	Improper wiring connection	Check and confirm the wiring connection or replace it if necessary
No automatic recording after device initialization	The Micro SD card may be either not inserted or not recognized	If the Micro SD card is inserted, power off the device, carefully remove and reinsert it/ Format or replace the memory card
Aborted video recording	The Micro SD card runs abnormally	Format or replace the Micro SD card (It is recommended to use a Class 10 memory card with a capacity of at least 32GB)
Blurry recording video footage	The lens protection film is not removed or there are stains on the lens or windshield	Remove the protection film, check lens surface, and clean up the stains
Unable to go online	The SIM card is out of service due to arrears	Recharge and pay the bill for the SIM card

	The SIM card is not correctly inserted or securely connected	Carefully remove the SIM card and then reinsert it
	The online parameter configurations are inaccurate	Reset the parameters according to the manual
	The vehicle is in areas characterized by weak signal reception, such as underground parking lots and tunnels	Leave from the areas with unreliable signal coverage
Unable to locate	The vehicle is in areas characterized by weak signal reception, such as underground parking lots and tunnels	Leave from the areas with unreliable signal coverage
	The terminal antenna is not oriented upwards	Adjust the position of the terminal

9. Precautions

- 9.1 The device is an electronic product. Please keep it away from water to prevent damage.
- 9.2 Before installation, it must be determined whether the user's power supply system is within the specified range. Exceeding the maximum rated voltage of the terminal can result in damage to the device.
- 9.3 It is recommended to power off the device when the ambient temperature exceeds the terminal's specified normal operating temperature range.
- 9.4 When the vehicle is in an underground parking lot, tunnel or garage, the positioning signal may be affected. Additionally, there could be a communication network signal blind spot, which may hinder the device's monitoring capabilities. Once the vehicle exits these areas, the device will automatically resume normal operation.
- 9.5 In case of abnormality, please do not repair it by yourself. The manufacturer is not responsible for damage caused by connecting non-original accessories or unplugging the connection between components.
- 9.6 This product is a safe driving assistance system aimed at enhancing road safety. The company is not liable for any losses or damages from system failures or data loss.
- 9.7 This product is an auxiliary device for the purpose of recording external images of the vehicle. Due to the different situation and environment of the vehicle, some functions will not be supported. In order to further improve the product, irregular firmware upgrades will cause changes in product performance, sometimes Due to the use environment, it may not be

possible to take pictures, so the driving images recorded by this product are for reference only, and the status of the Micro SD card will also lead to the situation that pictures cannot be taken.

9.8 Although this product can record and save the images of vehicle accidents, it does not guarantee that all accident images can be recorded, and the collision sensor cannot be activated by a slight collision accident, so the images may not be recorded in a special folder.

9.9 Be sure to Power off the device before inserting or unplugging the Micro SD memory card.

9.10 For the stable use of the product, it is recommended to format the memory card at least once a week.

9.11 General Micro SD cards have a finite service life, and prolonged use may result in data storage failures. In such cases, it is advisable to purchase a new Micro SD card to ensure continued reliable performance. The company will not be liable for any data loss resulting from prolonged usage of the Micro SD card.

9.12 Do not install or operate this product while the vehicle is moving.

9.13 Do not connect the uninterruptible power supply without authorization, as it may result in failure of the vehicle or product. For installation matters, please consult a qualified professional.

9.14 Do not expose this product to severe shocks or vibrations, as this may cause damage, leading to malfunction or render it inoperable.

9.15 Exceeding the operational temperature may result in product failure, fire, or explosion.